

TABS & BRACKETS



Shorten your build time with precision stamped tabs & brackets. Made from 4130 chromemoly .125" thick, unless noted.



#8102 1/4" Tube Tab
Single Right Support,
3/8" Hole



#8107 Small Uni-
versal Tab, Bent Edges,
3/8" Hole, .063" Thick



#8114 Flat Tube
Tab, 3/8" Hole



#8101 1/4" Tube Tab
Single Left Support,
3/8" Hole



#8110 Small Lever
Mounting Tab, 3/8"
Hole, .063" Thick



#8118 Flat Tube
Tab, 1/4" Hole



#8112 Radius Rod
Mount Tab, 1/2" Slot,
3/8" Hole



#8106 Mount Tab,
Bent Edges, 3/8" Hole



#8111 Rod End
Clevis, 1/2" Slot, 3/8"
Hole for 3/8" tubing



#8105 Flat Tab,
3/8" Hole



#8100 Tab, Motor
Plate, 3/8" Hole



#8113 Rod End
Clevis, 1/2" Slot, 3/8"
Hole for 3/8" tubing

INSTALLATION INSTRUCTIONS FOR FO-STYLE BUTTON



2. You then can use the Dzus transfer punch to mark the exact location of the button. Slip transfer punch into the tab and position the panel in the desired location. A gentle tap with a soft faced hammer will dimple the back side of the panel.

3. Drill or punch a 3/8" diameter hole located by the transfer punch mark. To use the dimpling tool, determine that the dimple will be towards the plate. Use 2 3/8" wrenches with the dimpling tool. Tighten until both sides of the tool are flush with the panel.

1. Determine where the Dzus plate is to be installed. A small break on the tab will allow the panel to fit flush with the tube. Install the spring on the back side of the tab using 1/8" x 3/8" steel pop rivets.

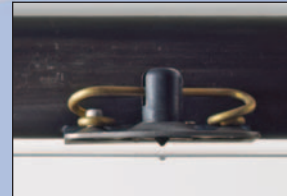

4. If a panel needs reinforcement, an optional panel doubler may be utilized. Be certain to check the spring tension for a positive lock when button is installed. The proper tool will aid in installation of the button.



5. The exploded view shows all of the components used in the above installation. More detailed instructions can be found at:
www.s-engineering.com



DZUS, BRACKETS, TABS AND BUILDER'S ACCESSORIES

S&S Engineering
596 Ayon Avenue
Azusa, CA 91702
800-922-9119
626-334-6018
626-334-6000 fax
orders@s-engineering.com
www.s-engineering.com

BUTTONS & SPRINGS



**Flat Head Buttons
Flush Mount**
FO 6 1/2 - 50 Button
FO 6 1/2 - 55 Button
FO 6 1/2 - 60 Button
FO 6 1/2 - 55 Button-Aluminum



Oval Head Buttons
AO 6 1/2 - 50 Button
AO 6 1/2 - 55 Button
AO 6 1/2 - 60 Button
AO 6 1/2 - 55 Button-Aluminum



Self Ejecting Buttons
EHF5 - 50 Button
EHFW5 - 50 Button-Wing
EHF6 - 55 Button

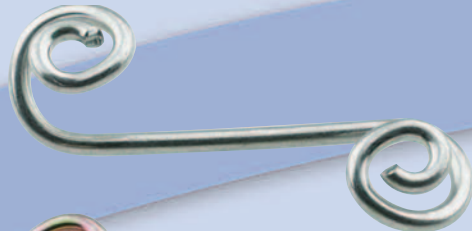

Springs
S5 X 225 Short Spring
S5 X 325 Tall Spring
S6 X 300 Short Spring
S6 X 425 Tall Spring
(Measured from the plate to the grip area.)

DZUS MOUNTING PLATES



AO Plate



FO Light Plate



FO Plate-Standard



FO Plate 3" Tall



EHF-5 Plate



EHF-6 Plate

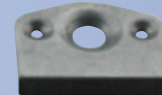

FO Plate-Bent

PANEL DOUBLERS FOR EXTRA STRENGTH

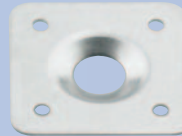

Square Panel Doubler



#10 Back-Up Washer

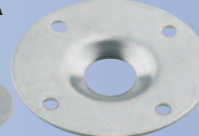

Round Panel Doubler

DZUS POCKET TOOL WRENCH



DZUS TRANSFER PUNCH

Accurately marks Dzus location on panels.

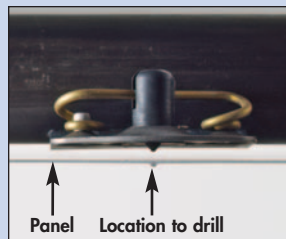

Panel Location to drill



DIMPLING TOOL



Installs the correct dimple for FO buttons.
Uses only hand tools.

HATCH LATCH

Used to secure roof hatches, side windows and access doors in all forms of racing. Two styles available:

Hatch Latch-Flat Hook

Hatch Latch-Long Hook



CLECOS

Used to secure panels for trial fit during construction.

3/16" Cleco Gold Color-Each

1/8" Cleco Copper Color-Each



CLECOS PLIERS

